

SUBLEASE

±1,843 Sq. Ft.

LIZOTTE

AND ASSOCIATES REAL ESTATE INC



10615 124 Street, Edmonton, AB

BRIGHT, TOP (2ND FLOOR) OFFICE UNIT

Property Highlights

- High exposure, fronting 124 street
- Existing furniture available for acquisition
- Lease includes access to shared kitchen and washrooms
- 4 dedicated parking stalls included
- Sublease runs until December 31, 2026



780.488.0888



www.lizotterealestate.com



#1200, 10117 Jasper Avenue
Edmonton, AB T5J 1W8



No warranty or representation, expressed or implied, is made as to the accuracy of the information contained herein, and same is submitted subject to errors, omissions, change of price, rental or other conditions, withdrawal without notice, and to any specific listing condition, imposed by our principals.

FOR SUBLEASE

Bright, Top (2nd floor) Office Unit

2nd Floor Plan ±1,843 Sq. Ft.

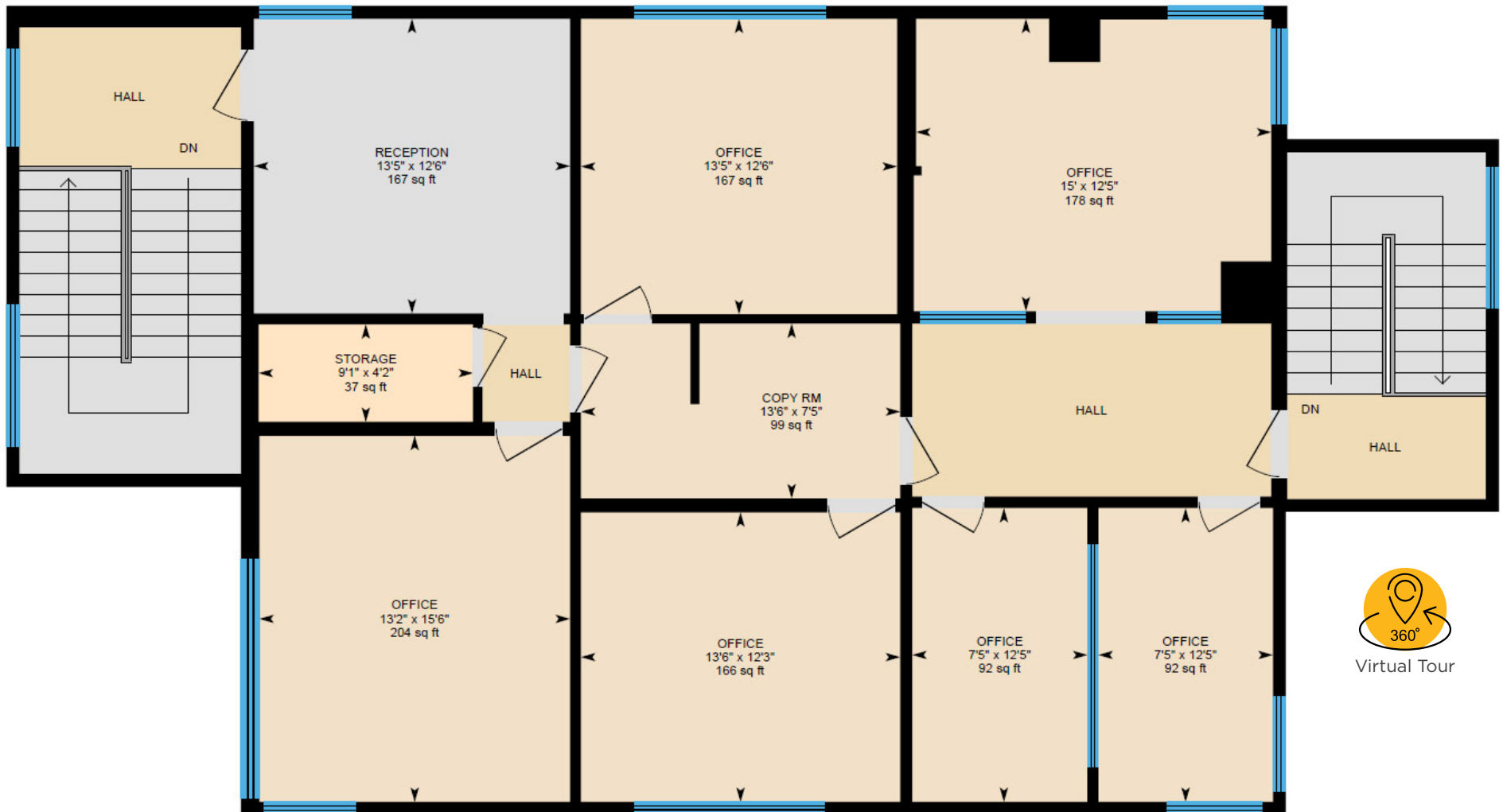

FOR SUBLEASE

Bright, Top (2nd floor) Office Unit

LIZOTTE
AND ASSOCIATES REAL ESTATE INC



Demographics within 5KM

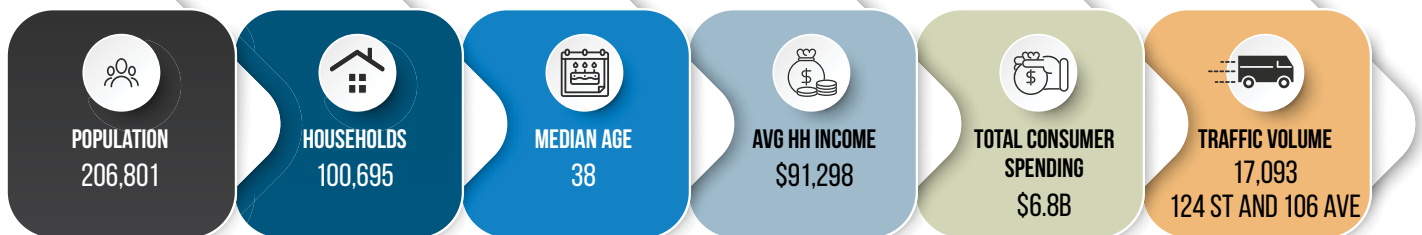

Contact

Chuck Clubine

Senior Associate
Cell: 780.264.7773
Direct: 780.784.6553
chuck@lizotttereaestate.com

Tom Dean

Associate
Cell: 780.920.8019
Direct: 780.784.6550
tom@lizotttereaestate.com

Vada Giguere

Executive Assistant
Direct: 780.784.6556
vada@lizotttereaestate.com



780.488.0888



www.lizotttereaestate.com



#1200, 10117 Jasper Avenue
Edmonton, AB T5J 1W8

No warranty or representation, expressed or implied, is made as to the accuracy of the information contained herein, and same is submitted subject to errors, omissions, change of price, rental or other conditions, withdrawal without notice, and to any specific listing condition, imposed by our principals.

FOR SUBLEASE

Bright, Top (2nd floor) Office Unit

LIZOTTE
AND ASSOCIATES REAL ESTATE INC

Property Information

Municipal Address: 10615 124 Street, Edmonton, AB

Legal Address: Plan RN22 Blk 24 Lot 8

Size: 1,843 Sq. Ft. (+/-)

Zoning: Mixed Use (MU)

Parking: 4 parking stalls included

Possession: Immediate/negotiable

\$\$\$

Lease Rate: \$30.00/Sq. Ft. Gross | ~\$4,607.50/month

Contact

Chuck Clubine

Senior Associate
Cell: 780.264.7773
Direct: 780.784.6553
chuck@lizotterealestate.com

Tom Dean

Associate
Cell: 780.920.8019
Direct: 780.784.6550
tom@lizotterealestate.com

Vada Giguere

Executive Assistant
Direct: 780.784.6556
vada@lizotterealestate.com



Virtual Tour

https://unbranded.youriguide.com/10615_124_st_edmonton_ab/

