

FOR SALE

±7,566 Sq. Ft. on
±0.74 Acres

LIZOTTE
AND ASSOCIATES REAL ESTATE INC



12215 William Short Rd NW, Edmonton, AB

WAREHOUSE WITH OFFICE BUILD-OUTS

Property Highlights

- Property features a durable wood/steel frame construction with a layout that includes a front reception area, various offices, kitchenette
- Rear warehouse and storage space, complemented by two grade loading doors
- The fully fenced yard and paved parking area ensure security and convenience
- With the current zoning, this location offers business opportunities
- Access to Fort Road, Wayne Gretzky Drive and Yellowhead Trail



780.488.0888



www.lizotterealestate.com



#1200, 10117 Jasper Avenue
Edmonton, AB T5J 1W8



No warranty or representation, expressed or implied, is made as to the accuracy of the information contained herein, and same is submitted subject to errors, omissions, change of price, rental or other conditions, withdrawal without notice, and to any specific listing condition, imposed by our principals.

FOR SALE

WAREHOUSE WITH OFFICE BUILD-OUTS

LIZOTTE
AND ASSOCIATES REAL ESTATE INC

Floor Plan

William Short Rd

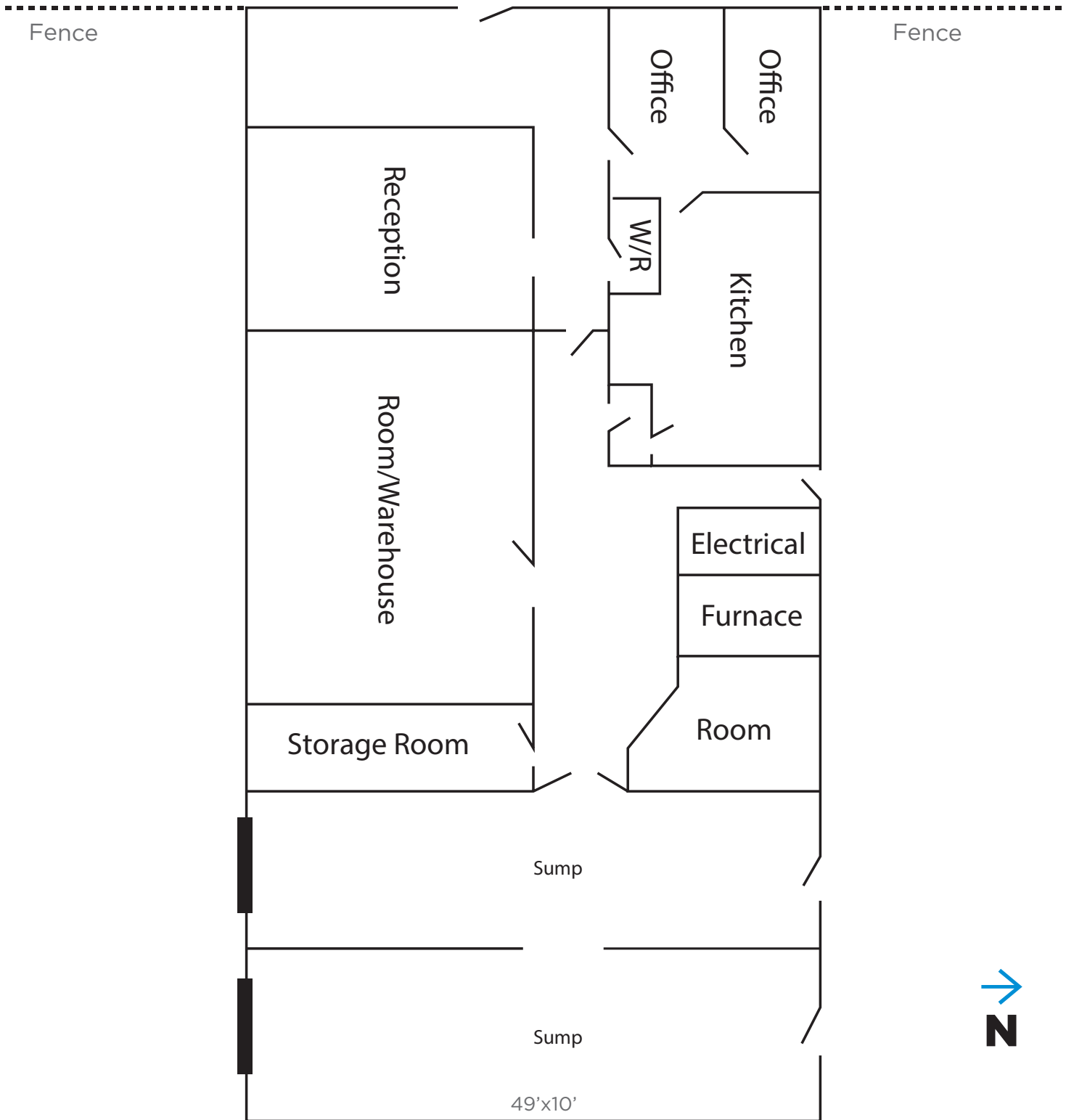

FOR SALE

WAREHOUSE WITH OFFICE BUILD-OUTS

LIZOTTE
AND ASSOCIATES REAL ESTATE INC



FOR SALE

WAREHOUSE WITH OFFICE BUILD-OUTS

LIZOTTE
AND ASSOCIATES REAL ESTATE INC

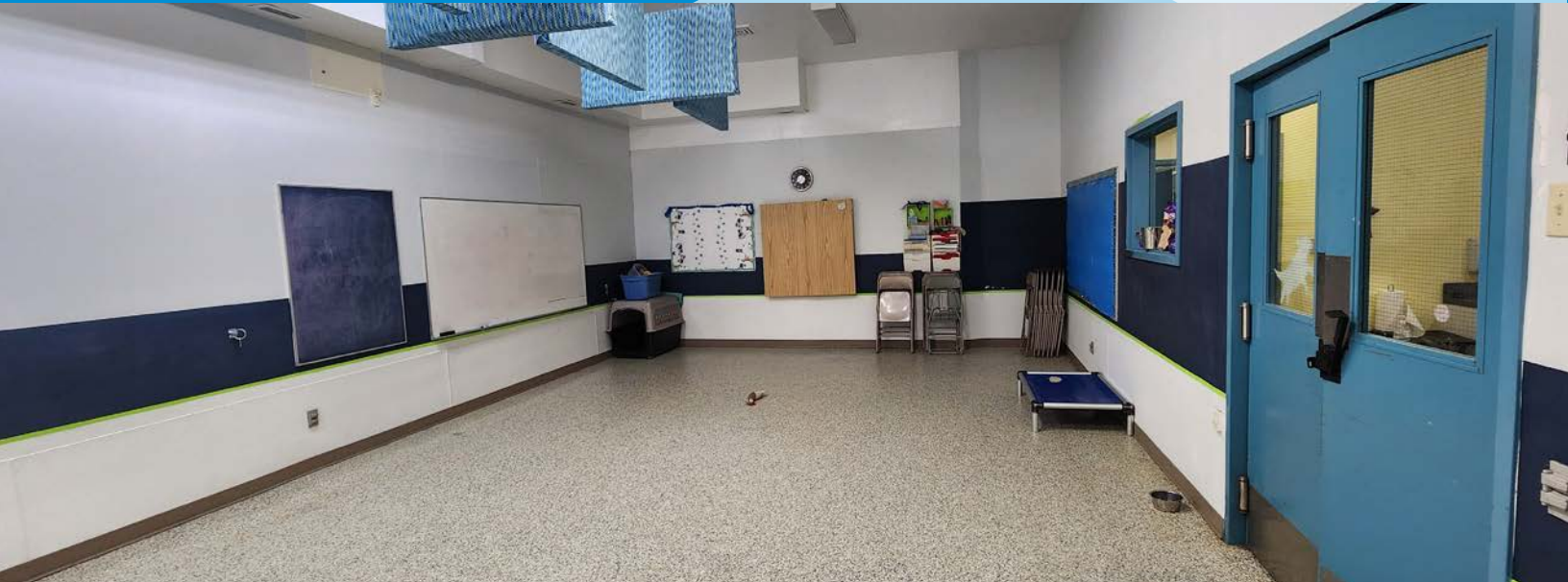

FOR SALE

WAREHOUSE WITH OFFICE BUILD-OUTS

LIZOTTE

AND ASSOCIATES REAL ESTATE INC

Property Information

Municipal Address: 12215 William Short Rd NW, Edmonton, AB

Legal Address: Lot 17, Block F Plan 0020945

Building Size: 7,566 Sq. Ft. (+/-)

Lot Size: 0.74 Acres (+/-)

Zoning: IM (Medium Industrial)

Parking: Ample/Paved

Sumps: 2 Sumps, 1 drain

Heating: 4 Radiant Tube heaters

Ceiling Height: 10'5" clear in warehouse

Loading: (2) 8'X10' Grade

Possession: Negotiable

**Tenant occupied/Negotiable*

Contact

Richard Lizotte

President/Broker

Cell: 780.292.1871

Direct: 780.784.5360

richard@lizotterealestate.com

Lee Berger

Associate Broker

Cell: 587.983.6654

Direct: 780.784.5363

lee@lizotterealestate.com

John Cuglietta

Unlicensed Assistant

Cell: 780.340.4384

Direct: 780.784.5357

john@lizotterealestate.com

Soudabeh Mobin

Unlicensed Assistant

Direct: 780.784.9583

soudabeh@lizotterealestate.com

\$\$\$

Purchase Price: \$1,450,000.00

Taxes: \$37,577.60 est 2024

