

FOR LEASE

LIZOTTE
AND ASSOCIATES REAL ESTATE INC



116/242/270 - 91 Street SW, Edmonton, AB
1,217-1,577 Sq. Ft. (+/-)

ELLWOOD CORNER RETAIL SPACE

Property Highlights

- 1,217 SF and 1,577 SF of prime main floor commercial retail space
- 1,447 SF of fully built-out medical space
- High exposure to over 33,100 vehicles per day along 91 street
- Easy access to Anthony Henday and Ellerslie Road
- Daytime population reaches a total of 33,100
- Gym, daycare, medical clinic, kick boxing & martial arts, Indian cuisine, cannabis, tailors and more on-site
- Ample on-site surface parking



780.488.0888



www.lizotterealestate.com



#1200, 10117 Jasper Avenue
Edmonton, AB T5J 1W8



No warranty or representation, expressed or implied, is made as to the accuracy of the information contained herein, and same is submitted subject to errors, omissions, change of price, rental or other conditions, withdrawal without notice, and to any specific listing condition, imposed by our principals.

FOR LEASE

Ellwood Corner Space

Retail Bay can accommodate multiple users under CB2 zoning

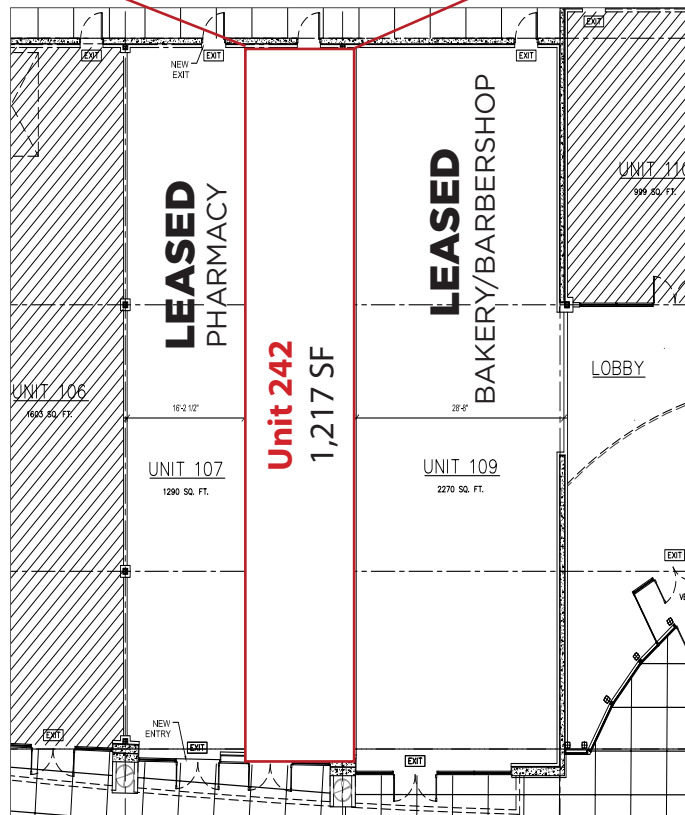
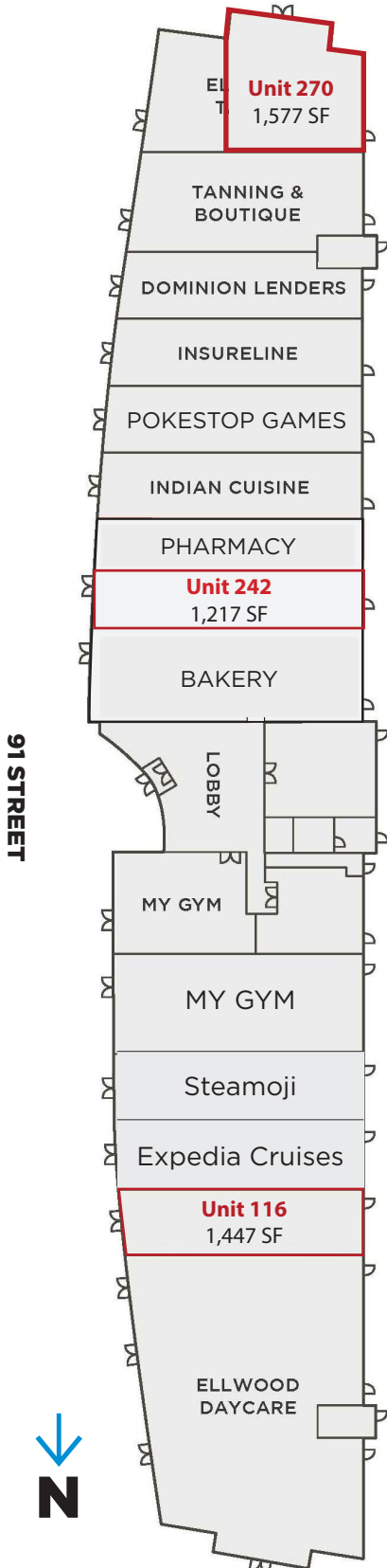

FOR LEASE

Ellwood Corner Space

COMMERCIAL RETAIL



COMMERCIAL RETAIL



BUILT-OUT MEDICAL

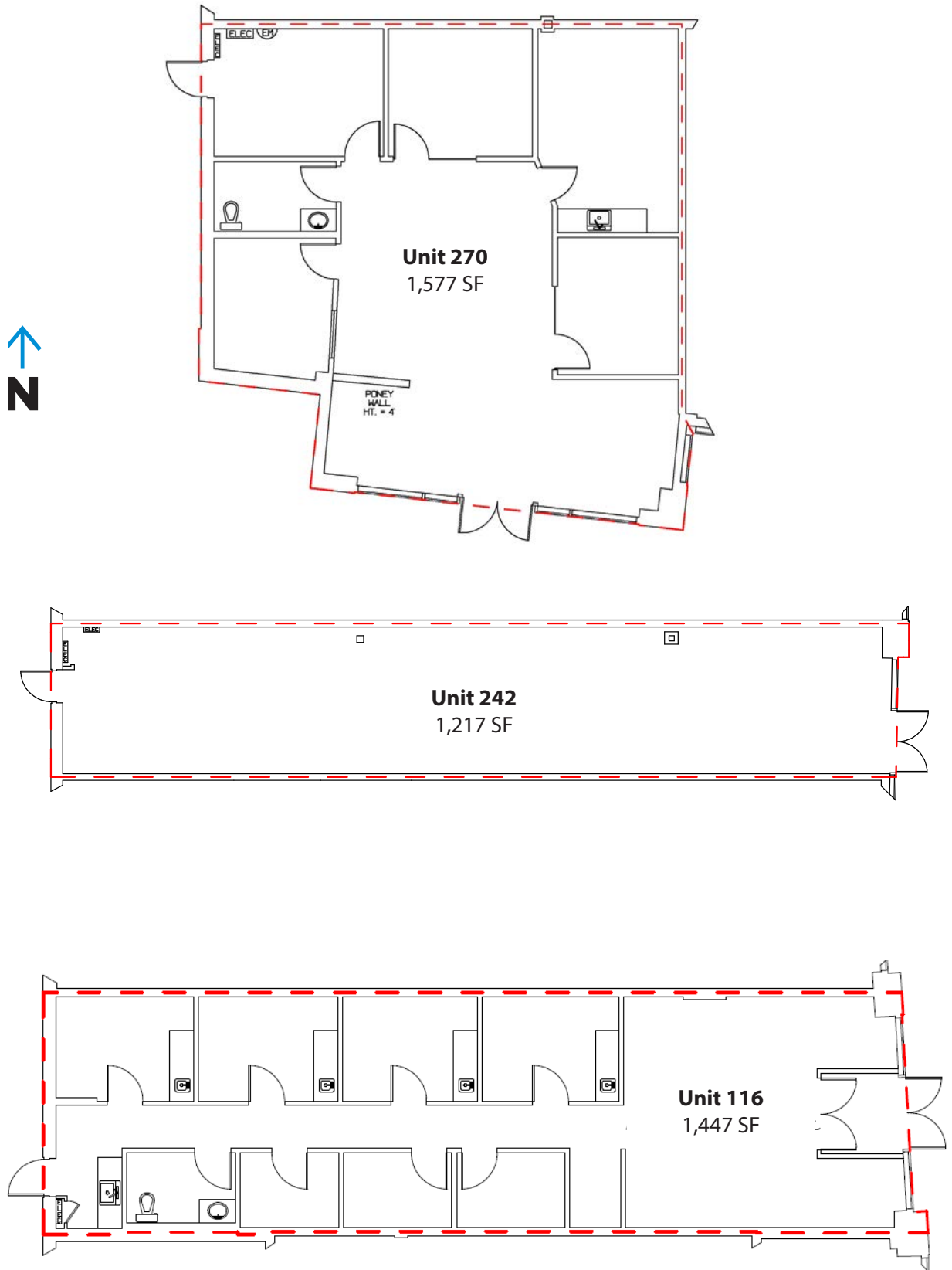

FOR LEASE

Unit 270 Ellwood Corner Space

LIZOTTE
AND ASSOCIATES REAL ESTATE INC



FOR LEASE

Ellwood Corner Retail Space

LIZOTTE
AND ASSOCIATES REAL ESTATE INC

Property Details

Address: 116/242/270 - 91 Street SW, Edmonton, AB

116 1,447 Sq. Ft. (+/-)

Size: **242** 1,217 Sq. Ft. (+/-)

270 1,577 Sq. Ft. (+/-)

Parking: 3.3 surface stalls per 1,000 Sq. Ft.

Possession: Immediate

Zoning: CB2

Lease Rate: \$32.00 /Sq. Ft.

Op. Costs: \$10.90/Sq. Ft. (Estimated For 2023)

Contact

David J. Olson
Senior Associate
Cell: 780.908.1650
Direct: 780.784.5356
david@lizotterealestate.com

Justin Sorensen
Associate
Cell: 780.257.6860
Direct: 780.784.9581
justin@lizotterealestate.com

Cynthia Leduc
Unlicensed Assistant
Direct: 780.784.5359
cynthia@lizotterealestate.com

Rohit™

COMMERCIAL | Bold Goes Further

