

# FOR SALE

7,498.51 Sq. Ft. (+/-)

# LIZOTTE

AND ASSOCIATES REAL ESTATE INC

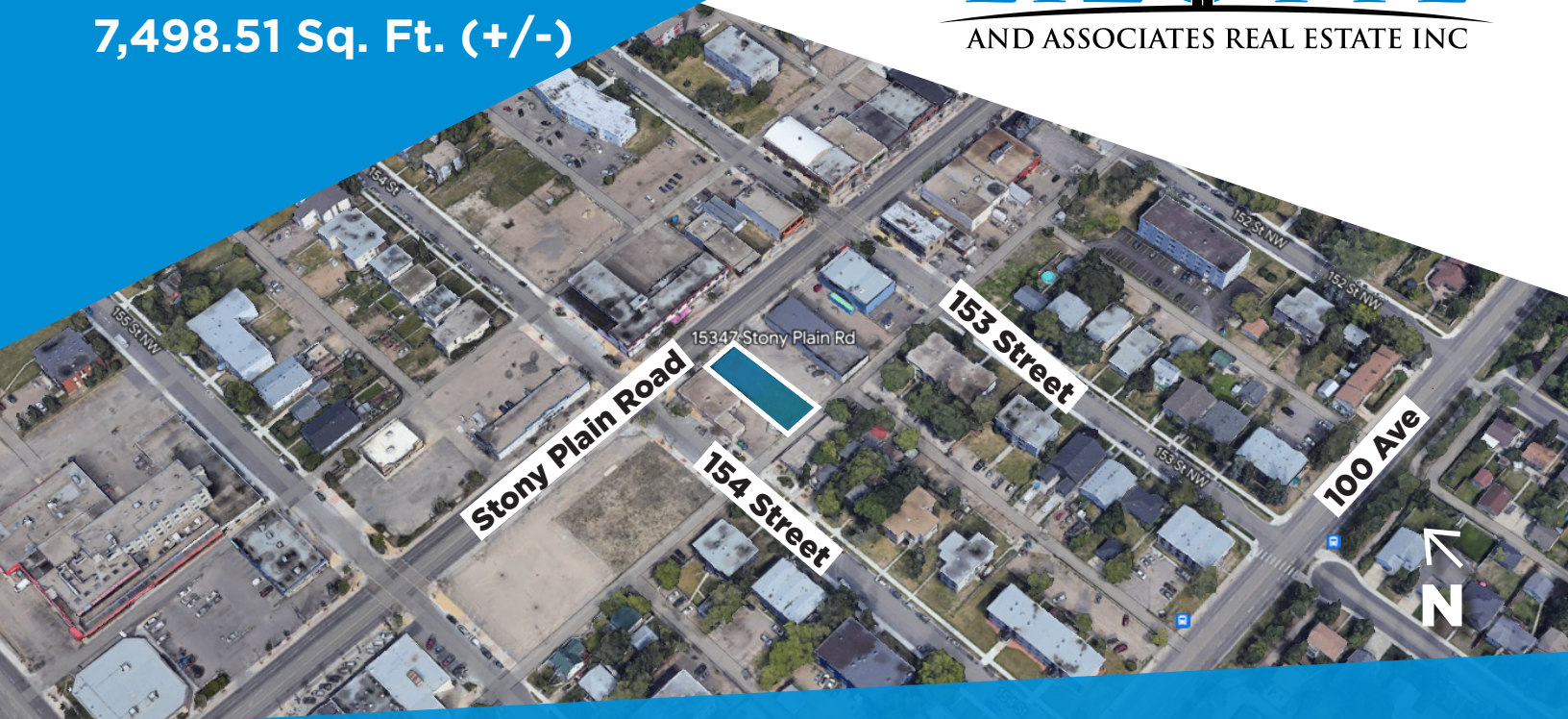

**15347 Stony Plain Road NW, Edmonton, AB**

## PRIME COMMERCIAL LAND

### Property Highlights

- High-profile development lot along the LRT Line, and all major public transportation routes
- (3) block from major LRT stop and Transit Hub
- Excellent opportunity for a first-time investor or developer
- Major road arteries in close proximity include Yellowhead Trail, Anthony Henday, 100 Ave, and 170 Street
- Landlord will entertain all reasonable offers



780.488.0888



[www.lizotterealestate.com](http://www.lizotterealestate.com)



#1200, 10117 Jasper Avenue  
Edmonton, AB T5J 1W8



No warranty or representation, expressed or implied, is made as to the accuracy of the information contained herein, and same is submitted subject to errors, omissions, change of price, rental or other conditions, withdrawal without notice, and to any specific listing condition, imposed by our principals.

# FOR SALE

7,498.51 Sq. Ft. (+/-)

# LIZOTTE

AND ASSOCIATES REAL ESTATE INC

## Property Information

**Municipal Address:** 15347 Stony Plain Road NW, Edmonton, AB

**Legal Address:** Plan 5229AD, Block 21, Lot 5

**Lot Size:** 7,498.51 Sq. Ft.

**Zoning:** General Business Zone (CB2)

**Possession:** Immediate/negotiable

\$\$\$

**Property Price:** \$869,990.00

## Demographics within 3KM

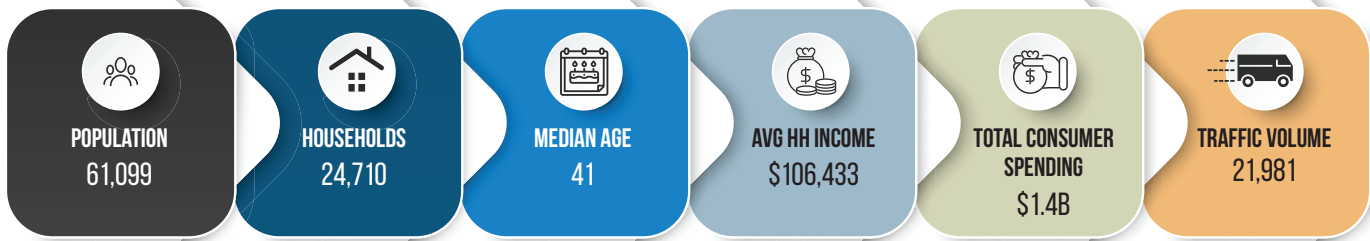

## Contact

**David J. Olson**

Senior Associate

Cell: 780.908.1650

Direct: 780.784.5356

david@lizotterealestate.com

**Justin Sorensen**

Associate

Cell: 780.257.6860

Direct: 780.784.9581

justin@lizotterealestate.com

**Soudabeh Mobin**

Unlicensed Assistant

Cell: 780.340.9595

Direct: 780.784.9583

soudabeh@lizotterealestate.com

