

FOR SALE

1,245 Sq. Ft. (+/-)

LIZOTTE

AND ASSOCIATES REAL ESTATE INC



4210 Gateway Blvd, Edmonton, AB

SALON BUSINESS FOR SALE

Property Highlights

- (4) chairs/stations, more can be added if needed
- (2) Hair washing stations
- State-of-the-art lighting throughout the space, floor-to-ceiling glass to offer ample natural light throughout the space
- Excellent POS system in place; Former “Beauty Core Hair Salon”
- Excellent parking and visibility onto Calgary Trail North and South and Whitemud Drive East and West
- Other uses could be Medical related, Destination Retail, Bakery etc.



780.488.0888



www.lizotterealestate.com



#1200, 10117 Jasper Avenue
Edmonton, AB T5J 1W8

No warranty or representation, expressed or implied, is made as to the accuracy of the information contained herein, and same is submitted subject to errors, omissions, change of price, rental or other conditions, withdrawal without notice, and to any specific listing condition, imposed by our principals.

FOR SALE

SALON BUSINESS FOR SALE

LIZOTTE
AND ASSOCIATES REAL ESTATE INC



Demographics within 2KM

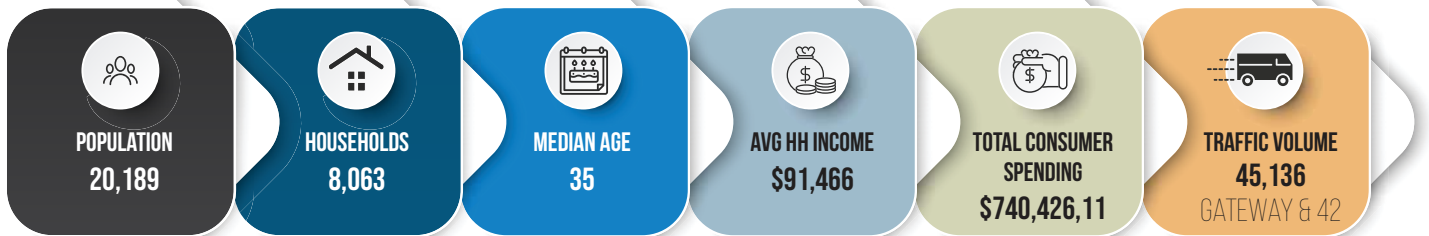

780.488.0888



www.lizotterealestate.com



#1200, 10117 Jasper Avenue
Edmonton, AB T5J 1W8

No warranty or representation, expressed or implied, is made as to the accuracy of the information contained herein, and same is submitted subject to errors, omissions, change of price, rental or other conditions, withdrawal without notice, and to any specific listing condition, imposed by our principals.

FOR SALE

SALON BUSINESS FOR SALE

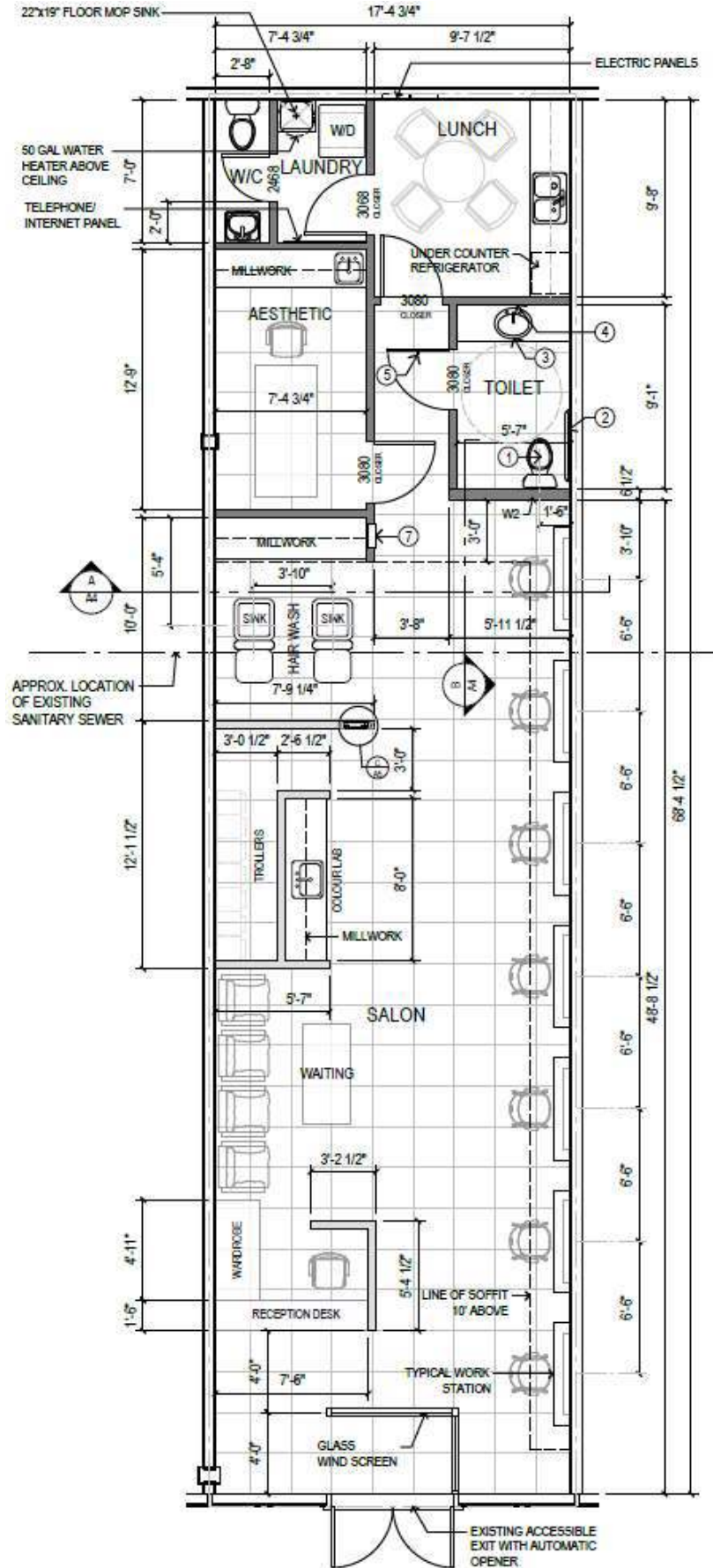

FOR SALE

4210 GATEWAY BLVD, EDMONTON, AB

LIZOTTE
AND ASSOCIATES REAL ESTATE INC

Property Information

Municipal Address: 4210 Gateway Blvd, Edmonton, AB

Legal Address: Lot 4 Block 5, Plan 9422309

Building Size: 1,245 Sq. Ft. (+/-)

Zoning: CB2 (General business zone)

Possession: Immediate

\$\$\$

Price: Contact Associate

Contact

David J. Olson
Senior Associate
Cell: 780.908.1650
Direct: 780.784.5356
david@lizotttereaalestate.com

Justin Sorensen
Associate
Cell: 780.257.6860
Direct: 780.784.9581
justin@lizotttereaalestate.com

Soudabeh Mobin
Unlicensed Assistant
Cell: 780.340.9595
Direct: 780.784.9583
soudabeh@lizotttereaalestate.com

