

FOR LEASE

1,133 - 4,506 Sq. Ft (+/-)

LIZOTTE

AND ASSOCIATES REAL ESTATE INC



11031 97 Street, Edmonton, AB

CENTURY PLAZA PROPERTY FOR LEASE

Property Highlights

- Large windows for ample natural light
- Great frontage on 97 Street
- Join neighboring Pharmacy and Medical Clinic
- Minutes from Royal Alexandra Hospital
- Ideal Tenant: Medical Professional, Personal Services, Bakery, Café, Quick Service Restaurant

Contact

David J. Olson

Senior Associate
Cell: 780.908.1650
Direct: 780.784.5356
david@lizotterealestate.com

Justin Sorensen

Associate
Cell: 780.257.6860
Direct: 780.784.9581
justin@lizotterealestate.com

Soudabeh Mobin

Unlicensed Assistant
Cell: 780.340.9595
Direct: 780.784.9583
soudabeh@lizotterealestate.com



780.488.0888



www.lizotterealestate.com



#1200, 10117 Jasper Avenue
Edmonton, AB T5J 1W8



No warranty or representation, expressed or implied, is made as to the accuracy of the information contained herein, and same is submitted subject to errors, omissions, change of price, rental or other conditions, withdrawal without notice, and to any specific listing condition, imposed by our principals.

FOR LEASE

CENTURY PLAZA

Floor Plan

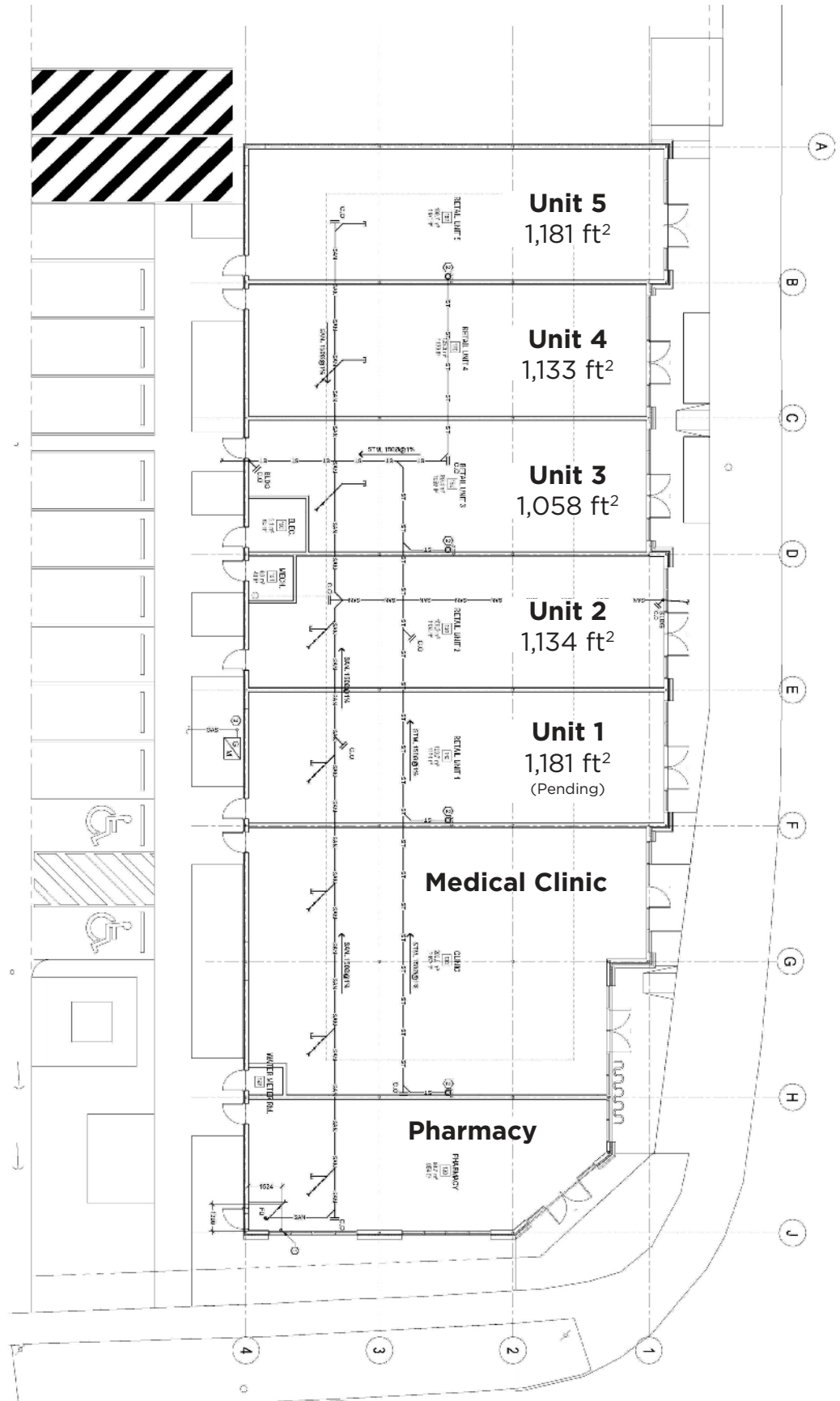

FOR LEASE

CENTURY PLAZA

LIZOTTE
AND ASSOCIATES REAL ESTATE INC

Property Information

Municipal Address: 11031 97 Street, Edmonton AB T5H 2H1

Legal Description: Lot 24A, Block 35, Plan 1821097

Size: **Unit 1:** 1,181 Sq.Ft. (+/-) (pending)

Unit 2: 1,134 Sq.Ft. (+/-)

Unit 3: 1,058 Sq.Ft. (+/-)

Unit 4: 1,133 Sq.Ft. (+/-)

Unit 5: 1,181 Sq.Ft. (+/-)

Zoning: Low-Intensity Business Zone (CB1)

Parking: Ample surface parking onsite and surrounding

Possession: Immediate/ negotiable

\$\$\$

Lease Rate: Market

Op. Costs: \$12.50 /Sq. Ft.



Contact Associate

David J. Olson
Senior Associate
Cell: 780.908.1650
Direct: 780.784.5356
david@lizotterealestate.com

Justin Sorensen
Associate
Cell: 780.257.6860
Direct: 780.784.9581
justin@lizotterealestate.com

Soudabeh Mobin
Unlicensed Assistant
Cell: 780.340.9595
Direct: 780.784.9583
soudabeh@lizotterealestate.com